

## **Bid Addendum No. 1 for:**

### **MASON TRANSIT AUTHORITY – PARK AND RIDE CONSTRUCTION PROJECT**

To: All Prospective Bidders

From: Patrick Holm, PE

RE: MASON TRANSIT AUTHORITY – PARK AND RIDE CONSTRUCTION PROJECT

All Bidders are required to make the following substitutions to the Bid Documents. Below is a description of the revisions made to the Contract Documents.

#### **Log Yard Road Park and Ride Plans:**

- Sheet SP-5 to SP-6: Added reference only note.
- Sheet PP-1: Added reference only note.
- Sheet PM-1: Added reference only note.
- Sheet WA-1: Replace with attachment WA-1 to include updated water plans
- Sheet WA-4: Replace with attachment WA-4 to include enlargement detail
- Sheet M3.1, General Note: **ADD** note:
  - 5. Fire sprinkler contractor to provide backflow assembly per code for fire sprinkler system in fire riser room 112.

#### **Specifications:**

- Special Provision 1-07.6 has been updated to remove the NPDES permit coverage for Pickering Road.
- Special Provision 8-02.3(4)A has been updated to clarify placement of topsoil.
- Special Provision 8-02.3(6)B has been removed.
- Special Provision 8-02.3(9)B has been modified to remove the reference to “The application rate shall be two pounds per 1000 square feet.”
- Special Provision 8-20.2 has been updated to have a new luminaire fixture.

#### **Bid Package:**

- Advertisement to Bid:
  - Revised – Fixed Google Maps Links.

#### **Clarifications/Additional Information:**

The following is additional information and clarification responding to questions from bidders:

- Are the piping/utilities shown on the stormwater ponds already installed as well?
  - The stormwater structures already constructed onsite are CB 3, CB 4, and the pipes from the bioretention facility to the storm pond, from CB 3 to the storm pond, and from CB 4 to the storm pond. The quarry spalls at those locations have been installed.
- Site grooving – what elevation has the site been graded to?
  - The site has been graded to  $\pm 0.5'$  of subgrade.
- Is stockpile usable for structural fill?
  - Yes, see Geotechnical Report. There is approximately 7,500 cubic yards of stockpiled soil.
- Is there a dedicated location to take export material?
  - No
- Has the C-Line been constructed already?
  - The C-Line frontage road has been constructed as part of the roundabout project. Construction goes all of the way to the concrete driveway entrance. The driveway extends to the end of the curb returns. "REFERENCE ONLY" notes have been added to the plans that have been constructed already.
- References to 03 00 00 Concrete will reference the WSDOT Standard Specification Division 5-05
- Contractor will be required to apply for NPDES Construction Stormwater General Permit Coverage for the Pickering Road Site.

**For Reference:**

- Digital CAD terrain models for Pickering Road and Log Yard Road park and rides:
  - [Download Link](#)
- Exhibit showing curb types at Log Yard Road park and ride
  - [Download Link](#)

**Attachments:**

- Advertisement to Bid
- Special Provision 1-07.6
- Special Provision 8-02.3(4)
- Special Provision 8-02.3(9)B
- Special Provision 8-20.2
- SP-5: Ramp Details
- SP-6: Ramp Details
- PP-1: Plan and Profile
- PM-1: Pavement Marking Plan
- WA-1: Water System Plan
- WA-4: Water Details

Mason Transit Authority  
Invitation to Bid  
MTA Park and Ride Construction Project

Mason Transit Authority (MTA), located in Shelton, Washington, requests Project Proposal SEALED BIDS for construction of the:

**MASON TRANSIT AUTHORITY**  
**MTA Park and Ride Construction Project**

The improvement(s) for which Project Proposals will be received is described below:

*Construction at four distinct park and ride locations:*

1. *Cole Road ([Google Maps](#)):  
Construction at this location will include pavement overlay, illumination, video surveillance, signing and striping and other work, all in accordance with the attached Contract Plans, these Contract Provisions, and the Standard Specifications.*
2. *Shelton-Matlock Road ([Google Maps](#)):  
Construction will include illumination, video surveillance, and other work, all in accordance with the attached Contract Plans, these Contract Provisions, and the Standard Specifications*
3. *Pickering Road ([Google Maps](#)):  
Construction at this location will include new pavement, pavement reconstruction, stormwater facilities, illumination, signing, striping, bus shelters and other work, all in accordance with the attached Contract Plans, these Contract Provisions, and the Standard Specifications.*
4. *Log Yard Road ([Google Maps](#)):  
Construction of a Park and Ride near the intersection of Log Yard Road and State Route 3 in Belfair which will include pavement, transit building, bus canopy, sidewalk, ADA facilities, stormwater facilities, septic system, illumination, signing, striping, and other work, all in accordance with the attached Contract Plans, these Contract Provisions, and the Standard Specifications. The transit building, bus canopy, and associated items will be broken out as a bid alternate in the schedule of values.*

Alternate Description:

*The transit building will include a new 3,000 square foot single story wood framed structure constructed on concrete slab, with new single slope single ply roofing construction. Exterior walls are a combination of wood siding and metal siding with anodized aluminum windows and doors. Interior are wood framed walls with gypsum and some ceramic tile with minimal interior finishes. Additional work includes hollow metal doors, frames and wood doors. Work includes full fire suppression system, mechanical, electrical, and plumbing systems.*

*The bus canopy will include a single story steel framed canopy with metal roofing. The canopy is open below the roof for the pass through of buses. Steel shall be painted.*

*Work includes sheet metal gutters, downspouts and trim, electrical, and fire suppression system.*

*On-site septic system will be included in the alternate.*

Bid Documents, including Plans and Special Provisions, may be obtained through Builders Exchange of Washington (<http://www.bxwa.com>) or MTA's Website (<http://www.masontransit.org>). Inquiries regarding the Project may be directed by contacting Patrick Holm at SCJ Alliance (360-352-1465 or [patrick.holm@scjalliance.com](mailto:patrick.holm@scjalliance.com) ).

Project Proposal SEALED BIDS must be received at the Mason Transit Authority Business Office reception desk located at 790 East Johns Prairie Road, Shelton, WA 98584 by 11:00a.m. on July 31, 2020 and MTA then and there will open and publicly read the bids. Bids may be submitted by mail or hand delivery only.

A pre-bid virtual walkthrough and question and answer session is planned for July 15<sup>th</sup> at 10:30a.m.

To join the video meeting, click this link: <https://meet.google.com/ans-msxw-yzc>

Otherwise, to join by phone, dial +1 304-916-7238 and enter this PIN: 705 700 853#

To view more phone numbers, click this link: <https://tel.meet/ans-msxw-yzc?hs=5>

Mason Transit Authority reserves the right to reject any and all bids without cause and to waive any informalities or irregularities. MTA reserves the right to award this Contract to the lowest responsive, responsible bidder based on the Bid Proposal.

ADVERTISED IN:           Mason Transit Authority Website [www.masontransit.org](http://www.masontransit.org)  
                                  Builders Exchange of Washington  
                                  Seattle Daily Journal of Commerce  
                                  Shelton Journal

1 (January 2, 2018)  
2 The Contracting Agency has obtained the below-listed permit(s) for this project. A copy of  
3 the permit(s) is attached as an appendix for informational purposes. Copies of these  
4 permits, including a copy of the Transfer of Coverage form, when applicable, are required  
5 to be onsite at all times.  
6  
7 Contact with the permitting agencies, concerning the below-listed permit(s), shall be  
8 made through the Engineer with the exception of when the Construction Stormwater  
9 General Permit coverage is transferred to the Contractor, direct communication with the  
10 Department of Ecology is allowed. The Contractor shall be responsible for obtaining  
11 Ecology's approval for any Work requiring additional approvals (e.g. Request for  
12 Chemical Treatment Form). The Contractor shall obtain additional permits as necessary.  
13 All costs to obtain and comply with additional permits shall be included in the applicable  
14 Bid items for the Work involved.  
15  
16 \*\*\*  
17 Cole Road:  
18 Mason County Land Modification Permit  
19  
20 Pickering Road:  
21 Mason County Land Modification Permit  
22  
23 Log Yard Road:  
24 Mason County Land Modification Permit  
25 Mason County Building Permit  
26 NPDES Construction Stormwater General Permit Coverage (Will be transferred upon  
27 award)  
28 Mason County Septic System Permit  
29  
30 \*\*\*

1  
2  
3  
4  
5  
6  
7  
8  
9  
10

(\*\*\*\*\*)

Topsoil Type A shall be placed to a non-compacted depth of \*\*\* 18 inches at bio-retention locations. All other locations shall have topsoil as specified on the plan.  
\*\*\* The topsoil shall be thoroughly blended prior to placement.

The Contractor shall submit a Type 1 Working Drawing consisting of independent test results from an accredited laboratory demonstrating the Topsoil Type A meets the requirements of Section 9-14.1(1). The Type 1 Working Drawing shall also include the Request for Approval of Material in accordance with Section 1-06.1(2).

1  
2  
3  
4  
5  
6  
7  
8  
9  
10  
11  
12  
13  
14  
15  
16  
17  
18  
19  
20  
21  
22  
23  
24  
25  
26  
27  
28  
29  
30  
31  
32  
33  
34  
35

(September 3, 2019)  
Seed of the following mix, rate, and analysis shall be applied at the rates shown below on all areas requiring \*\*\*hydro\*\*\* seeding within the project:

<u>Seed by Common Name, (Botanical Name), and "Source Identification"</u>	<u>Pounds Pure Live Seed (PLS) Per Acre</u>
*** 40% Jaguar Tall Fescue	70
30% Barclay Perennial Ryegrass	52
25% Red Creeping Fescue	44
5% Highland Colonial Bentgrass	9
Total	175 ***

Source Identified seed shall be generation four or less. Non-Source Identified seed shall meet or exceed Washington State Department of Agriculture Certified Seed Standards and be from within the appropriate genetic zones of the \*\*\* 7.0 \*\*\* Ecoregion(s) as defined by the US Environmental Protection Agency (EPA).

The seed certification class shall be Certified (blue tag) in accordance with WAC 16-302 and meet the following requirements:

Prohibited Weed	0% max.
Noxious Weed	0% max.
Other Weed	0.20% max.
Other Crop	0.40% max.

The Contractor shall document all Source Identified seed by providing the Association of Official Seed Certifying Agents (AOSCA) yellow seed label for each species in the mix. Site Identification Logs can be supplied for collections where the AOSCA yellow label is not available.

1 Section 8-20.2 is supplemented with the following:

2

3 ***Light and Signal Standards***

4 Section 8-20.2(9-29.6) is supplemented with the following:

5

6 Parking lot light standards and luminaire arm will be *HAPCO* series and black powder  
7 coated model number RTA25E8B4T2C-XX.

8

9 **Conventional Roadway Luminaires**

10 In Section 8-20.2(9-29.10(1)), Item A is revised to read as follows:

11

12 Parking lot luminaires shall be Cooper Lighting LED Archeon L series model ARCH-  
13 L-AF72-90-D-U-XX-7030-4N7-10K-BK

14



MATCH C-LINE 53+20 (SEE THIS SHEET)

C-LINE

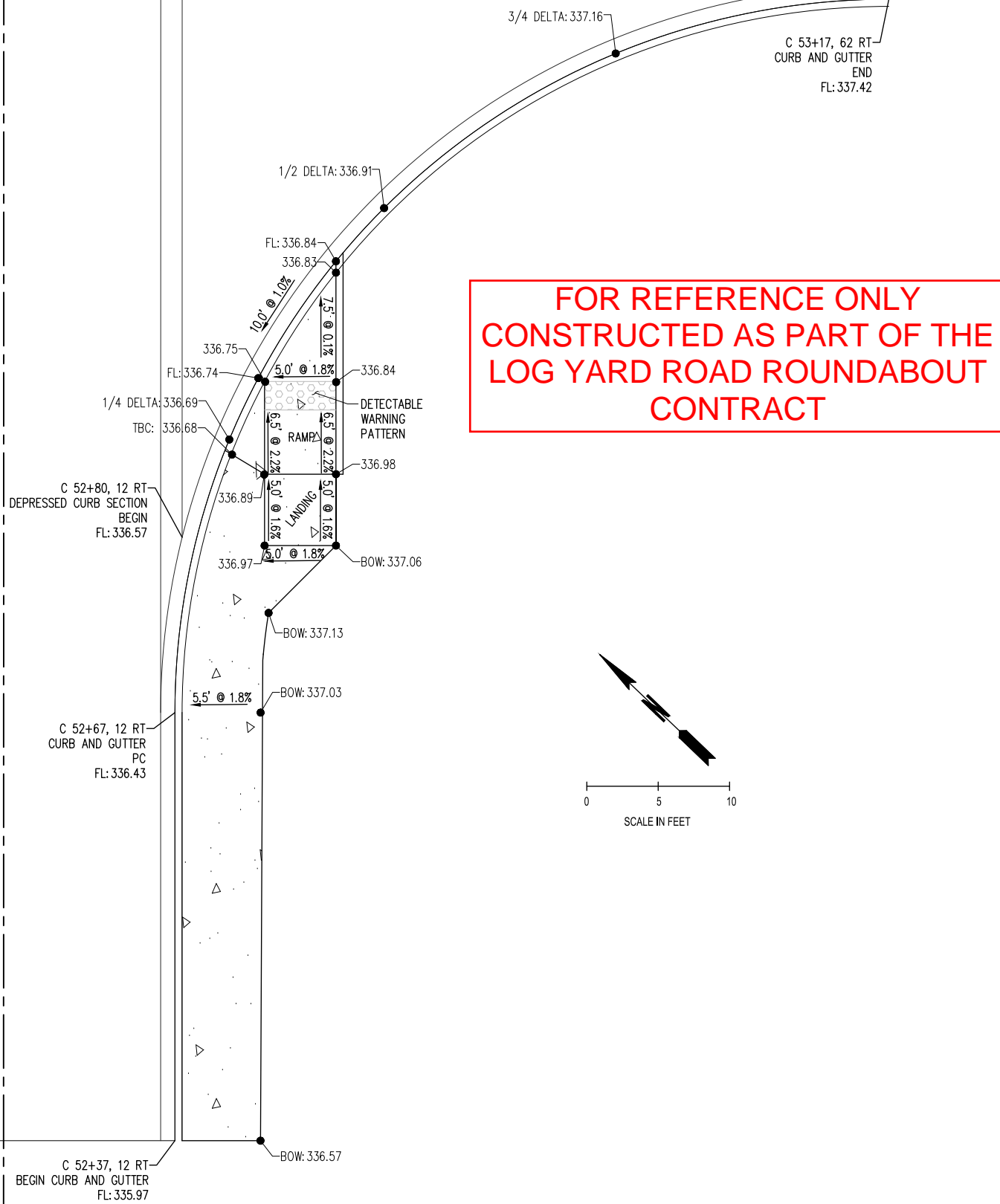

FOR REFERENCE ONLY  
CONSTRUCTED AS PART OF THE  
LOG YARD ROAD ROUNDABOUT  
CONTRACT

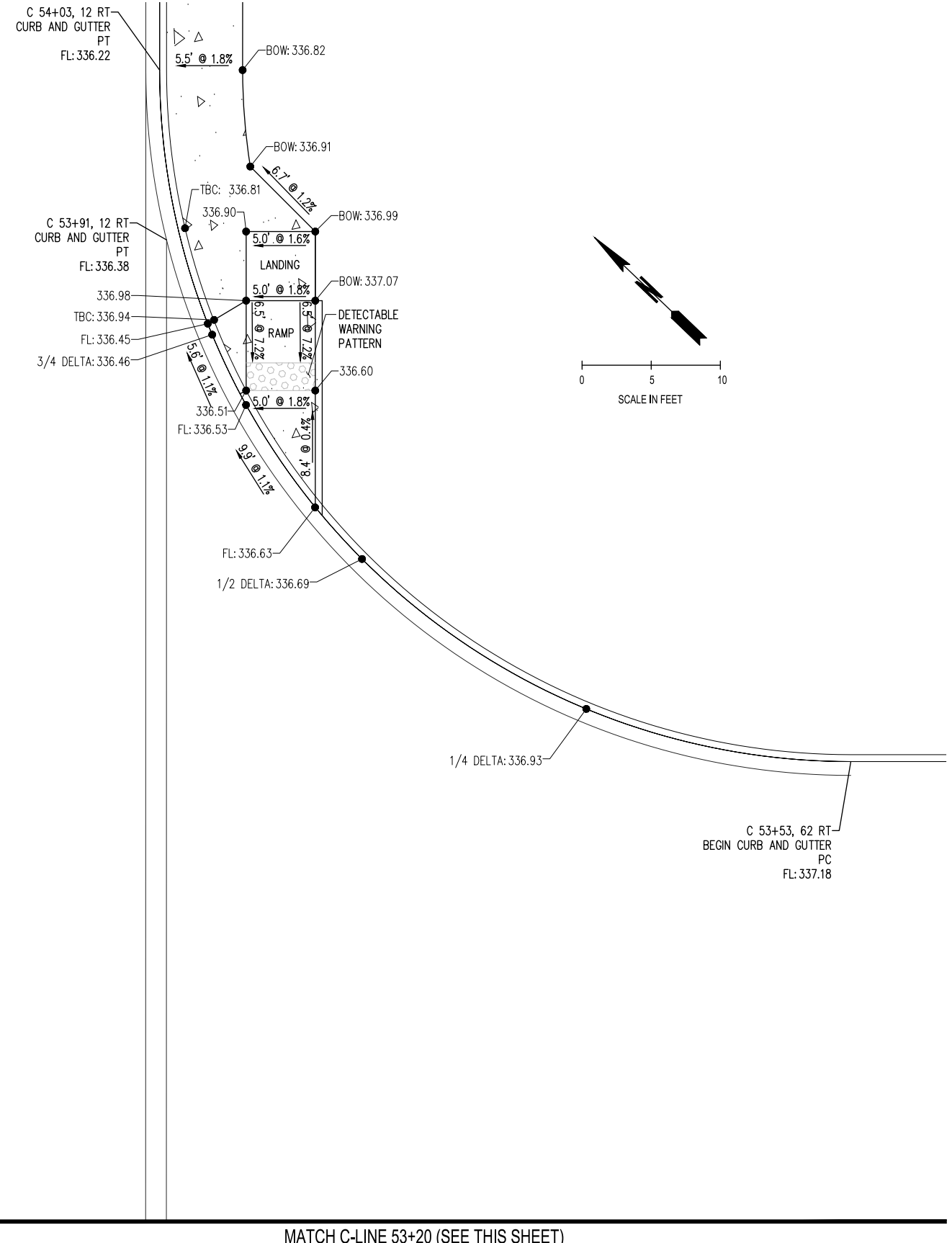
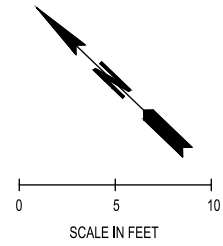

C-LINE

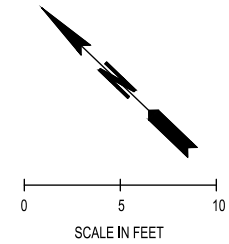

MATCH C-LINE 53+20 (SEE THIS SHEET)

I:\05\_2020\_6\_15\_12pm\_11am\_mtl\mofield\PROJECTS\0738 MASON TRANSIT AUTHORITY\0738.05 MTA PARK AND RIDE DEVELOPMENT\CADD\BELFAIR\0738.05-SP-5-B.DWG

REVISIONS	DATE	BY	DESIGNED BY:	ISSUE DATE:
1	7/24/20	SCJ	P. HOLM	07/08/2020
			DRAWN BY: N. MAYFIELD	JOB No.: 0738.05
			CHECKED BY: P. HOLM	DRAWING FILE No.: 0738.05-SP-5-B

ALL DIMENSIONS SHOWN IN FEET UNLESS OTHERWISE DESIGNATED

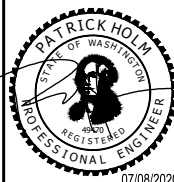

**SCJ ALLIANCE**  
CONSULTING SERVICES  
8730 TALLON LANE NE, SUITE 200, LACEY, WASHINGTON 98516  
P: 360-352-1465 F: 360-352-1509  
SCJALLIANCE.COM

PROJECT NAME:

MASON TRANSIT AUTHORITY  
BELFAIR  
PARK AND RIDE DEVELOPMENT

RAMP GRADING DETAILS

DRAWING No.:  
SP-5

SHEET No.:  
9 OF 86

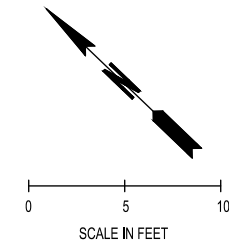
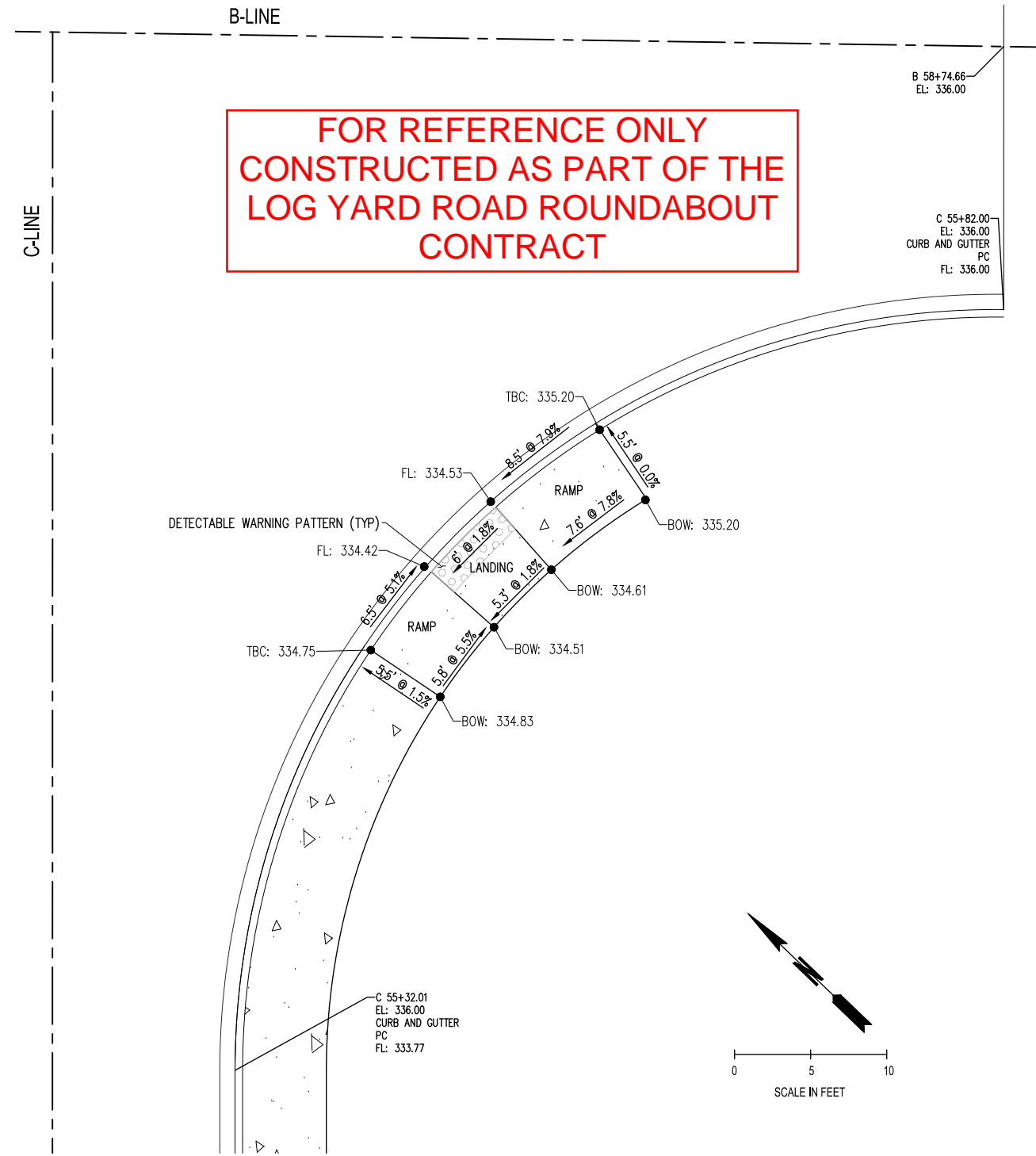
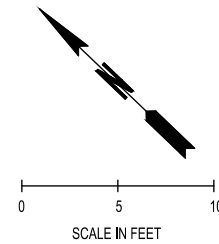
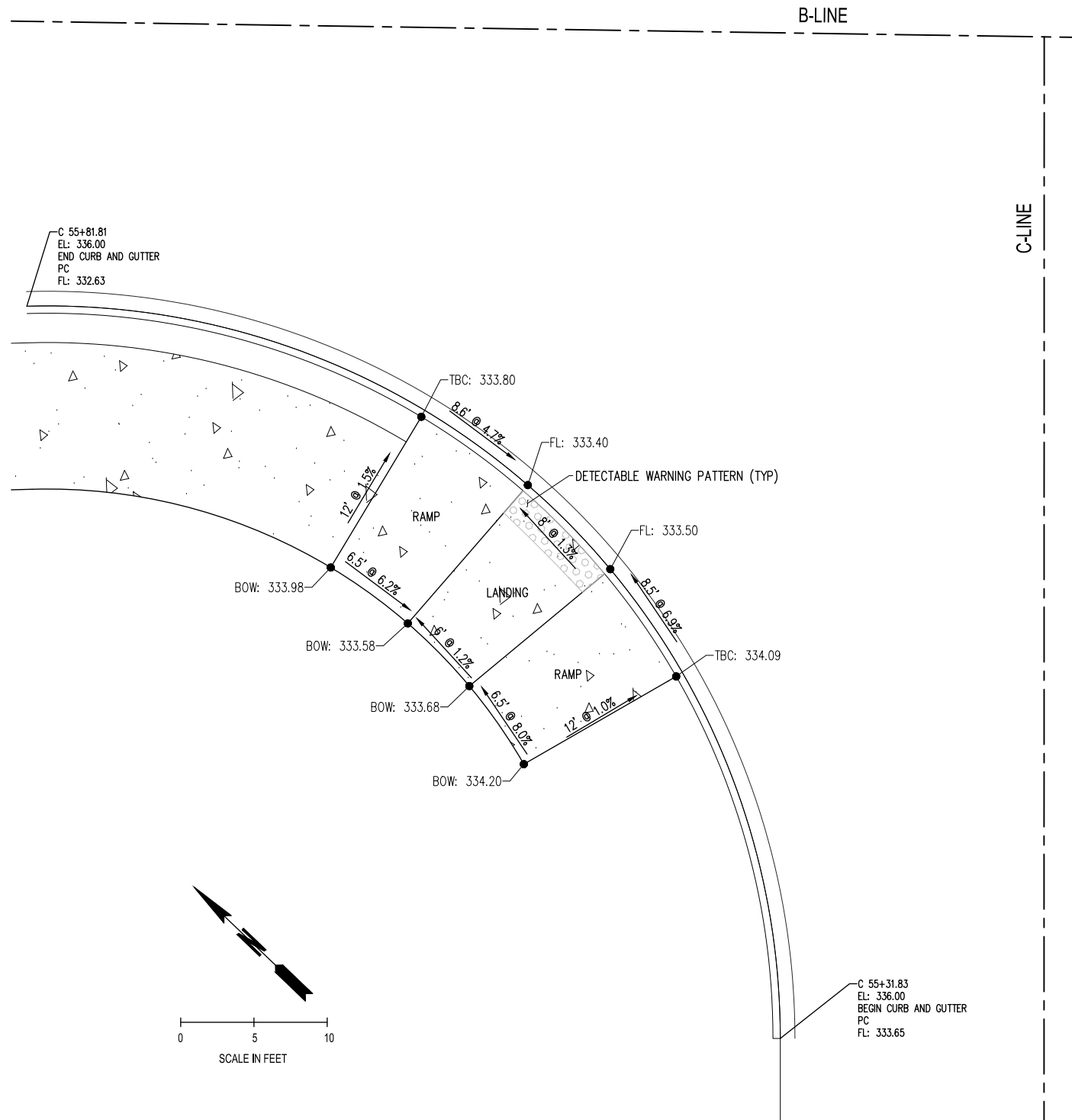

U:\05\_2020\_6\_05\_24.mxd User: mholm\p.holm\field IN:\PROJECTS\0738 MASON TRANSIT AUTHORITY\0738.05 MTA PARK AND RIDE DEVELOPMENT\CADD\BELFAIR\0738.05-SP-6-BUILD

Δ	REVISIONS	DATE	BY	DESIGNED BY:	ISSUE DATE:
1	BID ADDENDUM 1	7/24/20	SCJ	P. HOLM	07/08/2020
				DRAWN BY:	JOB No.:
				N. MAYFIELD	0738.05
				CHECKED BY:	DRAWING FILE No.:
				P. HOLM	0738.05-SP-6-B

ALL DIMENSIONS SHOWN IN FEET UNLESS OTHERWISE DESIGNATED

**SCJ ALLIANCE**  
CONSULTING SERVICES  
8730 TALLON LANE NE, SUITE 200, LACEY, WASHINGTON 98516  
P: 360-352-1465 F: 360-352-1509  
SCJALLIANCE.COM

PROJECT NAME:

MASON TRANSIT AUTHORITY  
BELFAIR  
PARK AND RIDE DEVELOPMENT

RAMP GRADING DETAILS

DRAWING No.: SP-6  
SHEET No.: 10 OF 86

T. 23 N., R. 01 W., S. 21, W.M.

LEGEND

- PROPERTY LINE
- CEMENT CONCRETE TYPE C-1 CURB (SEE DETAIL SHEET XS-1)
- CEMENT CONCRETE TRAFFIC CURB AND GUTTER (SEE DETAIL SHEET XS-1)
- SIGN
- CONCRETE SIDEWALK (SEE DETAIL SHEET XS-1)
- DETECTABLE WARNING PATTERN
- HEAVY DUTY ASPHALT PAVING (SEE DETAIL SHEET XS-1)

INTERSECTION CURVE TABLE								ELEVATIONS				
No	BEGIN STA	OFFSET	END STA	OFFSET	RADIUS	LENGTH	DELTA	BEGIN ELEV	1/4 Δ ELEV	1/2 Δ ELEV	3/4 Δ ELEV	END ELEV
C1	B 57+46.24	19.44 RT	C 55+31.83	18.00 LT	50.00	78.54	89°59'52"	332.67	333.05	333.05	332.93	333.03
C2	C 55+32.00	12.00 RT	B 24+17.54	18.00 RT	50.00	78.54	90°00'08"	333.66	333.79	334.09	334.78	335.46
C3	C 52+67.46	12.00 RT	C 53+17.46	62.00 RT	50.00	78.54	90°00'09"	336.08	335.55	336.37	336.51	336.64
C4	C 53+53.46	62.00 RT	C 54+03.46	12.00 RT	50.00	78.54	90°00'14"	337.18	336.57	335.98	335.51	334.87

ELEVATIONS PROVIDED ARE TO BOTTOM FACE OF CURB WITHIN CURB LIMITS, OR TO EDGE OF PAVEMENT WHERE NO CURB EXISTS.

FOR REFERENCE ONLY  
CONSTRUCTED AS PART OF THE  
LOG YARD ROAD ROUNDABOUT  
CONTRACT

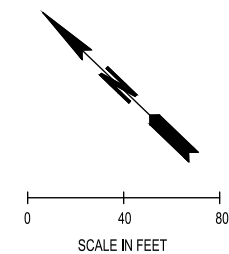
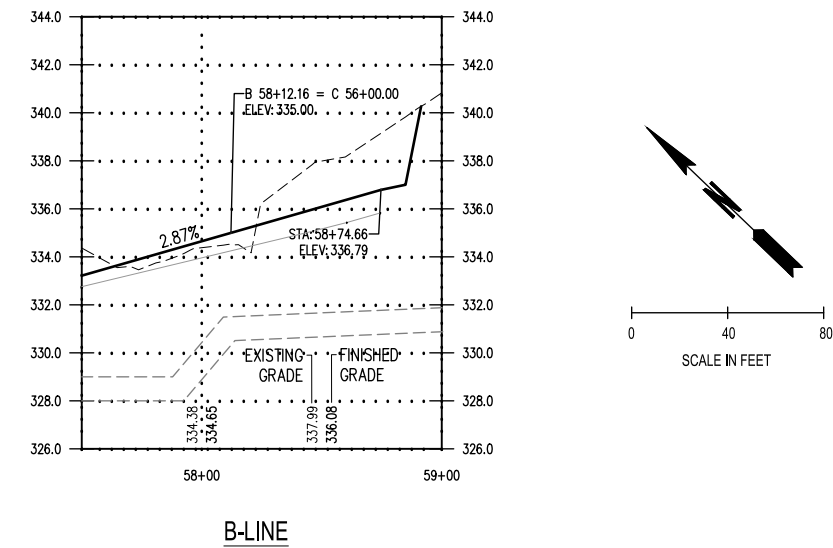
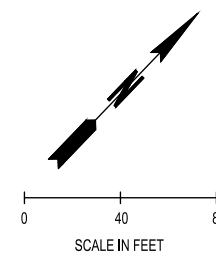
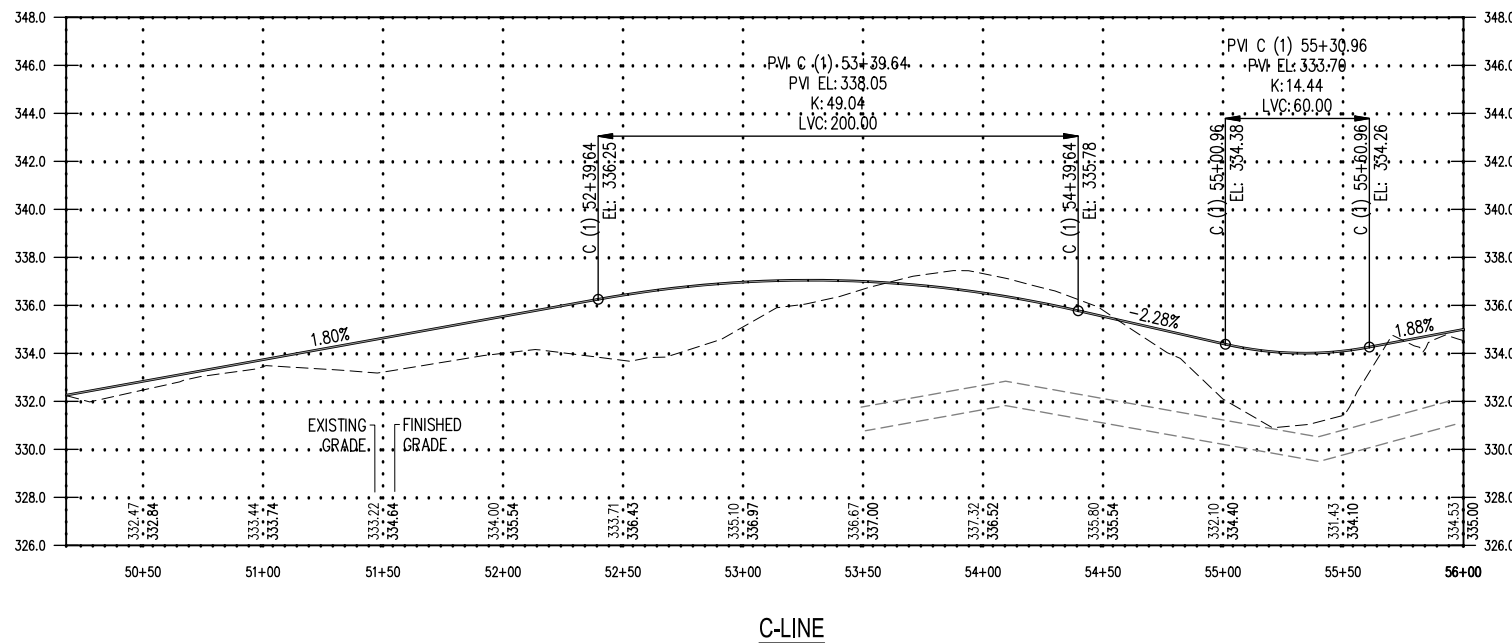
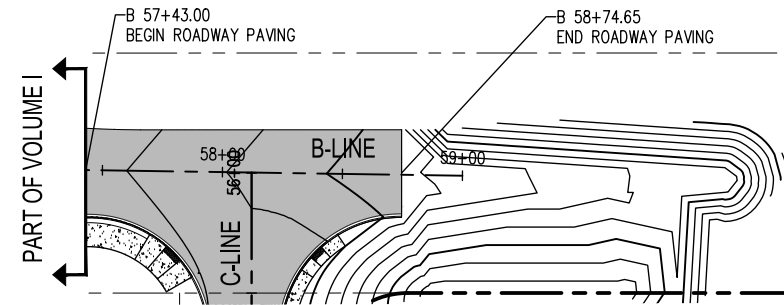
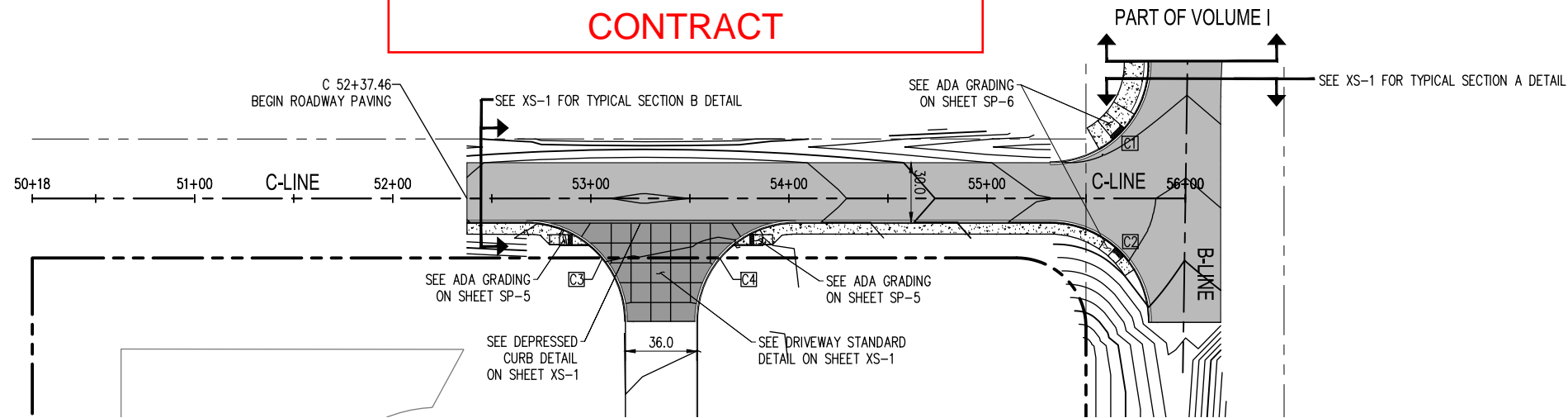

PAVING NOTES:

1. ALL CURB AND GUTTER, STREET GRADES, SIDEWALK GRADES, AND ANY OTHER VERTICAL AND/OR HORIZONTAL ALIGNMENT SHALL BE STAKED BY AN ENGINEERING OR SURVEYING FIRM CAPABLE OF PERFORMING SUCH WORK.
2. INSTALL DETECTABLE WARNING SURFACE PER WSDOT STANDARD PLAN F-45.10 AT ALL PEDESTRIAN CROSSING LOCATIONS.
3. STATION AND OFFSETS ARE TO FACE OF CURB.
4. INSTALL 0.33' COMPACTED DEPTH OF CRUSHED SURFACING BASE COURSE BENEATH DRIVEWAY ENTRANCE CONCRETE.
5. EOP = EDGE OF PAVEMENT

U:\05\_2020\_6\_15\_14m User: mitch\_mayfield\PROJECTS\0738 MASON TRANSIT AUTHORITY\0738.05 MTA PARK AND RIDE DEVELOPMENT\CADD\BELFAIR\0738.05-PP-1-BUILD

NO	REVISIONS	DATE	BY	DESIGNED BY:	ISSUE DATE:
1	BID ADDENDUM 1	7/24/20	SCJ	P. HOLM	07/08/2020
				DRAWN BY: N. MAYFIELD	JOB No.: 0738.05
				CHECKED BY: P. HOLM	DRAWING FILE No.: 0738.05-PP-1-B

ALL DIMENSIONS SHOWN IN FEET UNLESS OTHERWISE DESIGNATED

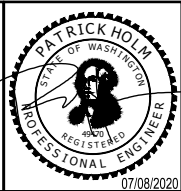

**SCJ ALLIANCE**  
CONSULTING SERVICES  
8730 TALLON LANE NE, SUITE 200, LACEY, WASHINGTON 98516  
P: 360-352-1465 F: 360-352-1509  
SCJALLIANCE.COM

PROJECT NAME:

MASON TRANSIT AUTHORITY  
BELFAIR  
PARK AND RIDE DEVELOPMENT  
PLAN, PROFILE, AND PAVING

DRAWING No.:  
PP-1  
SHEET No.:  
14 OF 86





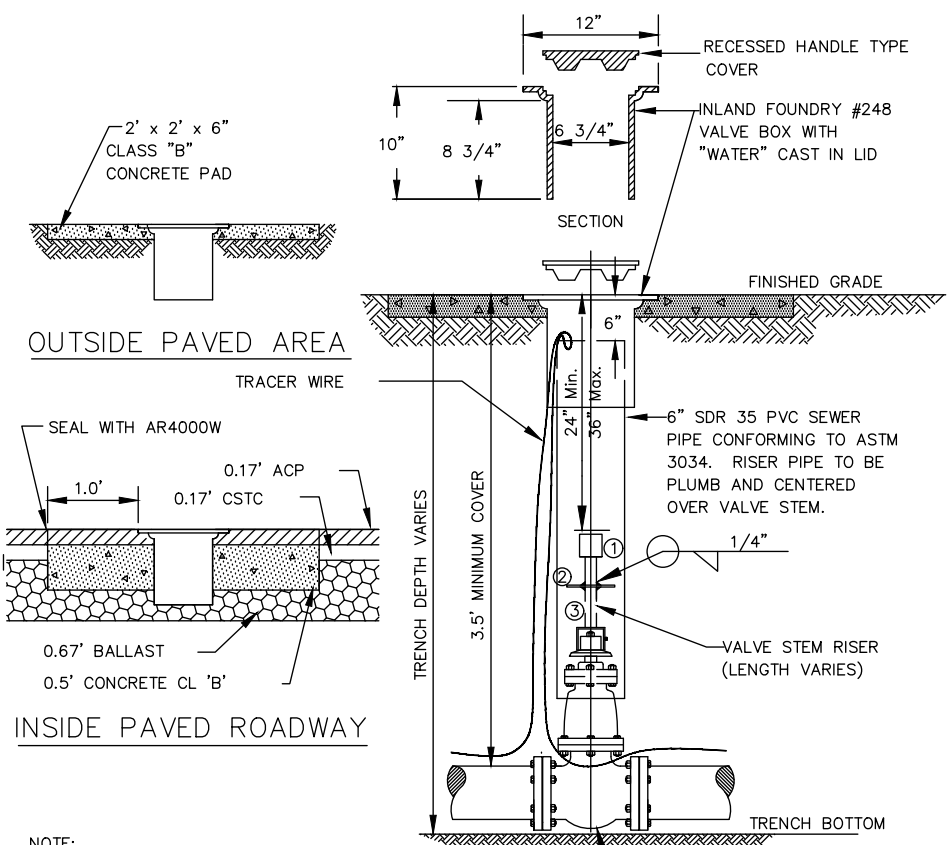

NOTE:  
ALL VALVES MUST HAVE 14 GAUGE COATED COPPER TRACER WIRE TIED OFF AT VALVE BODY, EXTENDED OUTSIDE PVC RISER PIPE THEN EXTENDED ONE FOOT TOP OF VALVE BOX.

**VALVE STEM EXTENSION LEGEND**

- ① VALVE OPERATING NUT OR 1 7/8" X 1 7/8" X 2" HIGH GRADE STEEL WELDED TO GUIDE PLATE.
- ② 3/16" Thk X 5 1/5" DIA STEEL GUIDE PLATE WELDED TO RISER SHAFT.
- ③ 2"x2"x 3/16" SQUARE STRUCTURAL STEEL TUBING TO FIT OPERATING NUT. LENGTH AS REQUIRED.

NOTE:  
ALL WELDS TO SHAFT SHALL BE FILLET WELD ALL AROUND, AS SPECIFIED ABOVE

**STANDARD VALVE BOX**

NTS

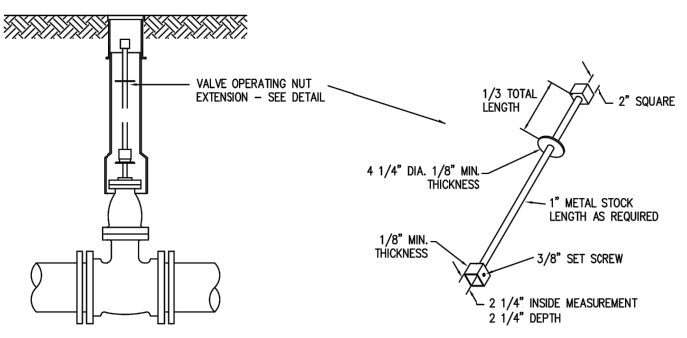

**VALVE OPERATING NUT EXTENSION**

EXTENSIONS ARE REQUIRED WHEN THE VALVE NUT IS MORE THAN THREE (3) FEET BELOW FINISHED GRADE. EXTENSIONS ARE TO BE A MINIMUM OF ONE (1) FOOT LONG, ONLY ONE EXTENSION PER VALVE. ALL EXTENSIONS ARE TO BE MADE OF STEEL SIZED AS NOTED, AND PAINTED WITH TWO COATS OF CARBON ELASTIC (ATCO NO. 2221) OR APPROVED EQUAL.

**VALVE MARKER POST**

PROVIDE A VALVE MARKER POST FOR EACH VALVE. THE FIBERGLASS VALVE MARKER POST SHALL BE BLUE IN COLOR, 4" WIDE (FLAT), 72" LONG AND FURNISHED WITH A 2"x2" HIGH-INTENSITY WHITE REFLECTOR (250 CANDLEPOWER) AND A FLEXIBLE ANCHOR BARB.

THE VALVE MARKER POST SHALL BE A CARSONITE CURV-FLEX MARKER OR DISTRICT APPROVED EQUAL.

THE POST SHALL BE SITUATED IN A SAFE, REASONABLY CONSPICUOUS LOCATION, AND AT A RIGHT ANGLE TO THE ROADWAY FROM THE VALVE.

THE DISTANCE FROM THE MARKER TO THE VALVE SHALL BE WRITTEN ON THE BACK OF THE MARKER IN 1-1/2" HIGH BLACK LETTERS.

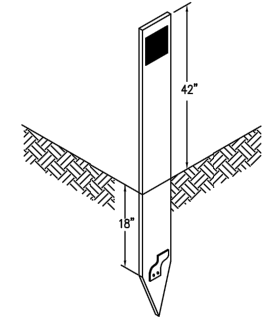

**GENERAL MISCELLANEOUS DETAILS**



Belfair Water District  
Standard Water Details

**Valve Marker/Valve Extension**

REVISED: OCTOBER 2019



**Valve Marker/Valve Extension**

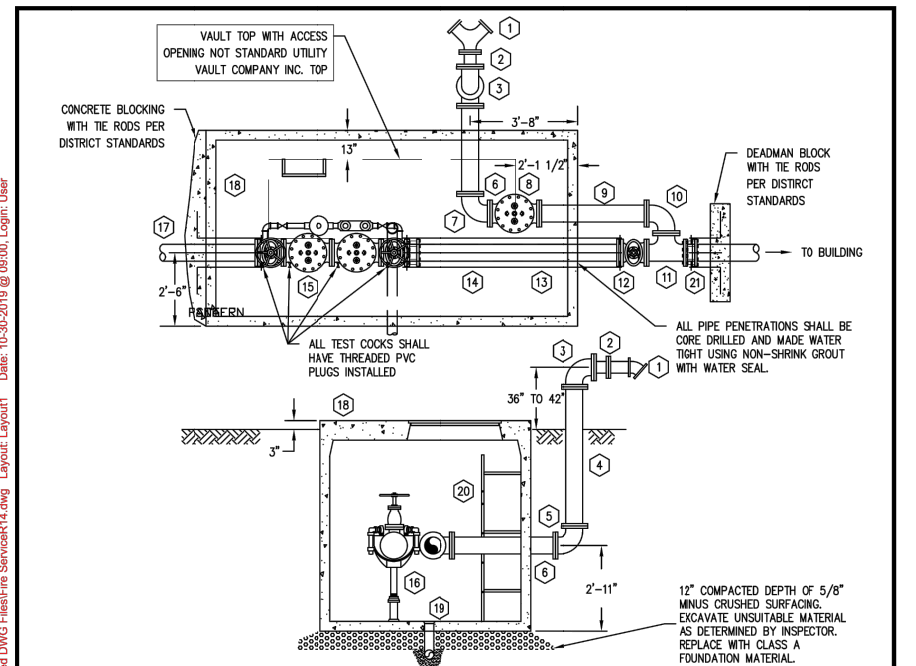

- LEGEND**
- 1. 4" STORTZ ADAPTER CONNECTION FOR STAND PIPE WITH BREAKABLE CAST IRON HOSE CAPS.
  - 2. 4" ADAPTER (FLXSCREWED)
  - 3. 4" OR 6" 90° BEND (FL)
  - 4. 4" OR 6" PIPE (FLxFL), LENGTH TO FIT
  - 5. 4" OR 6" 90° BEND (FL)
  - 6. 4" OR 6" PIPE (FLxFL), 3'-0" LONG
  - 7. 4" OR 6" 90° BEND (FL)
  - 8. 4" OR 6" SWING TYPE GRAVITY OPERATED CHECK VALVE (FL)
  - 9. 4" OR 6" PIPE (FLxFL), 3'-8" LONG
  - 10. 4" ASSEMBLY: 4" SHORT RADIUS 90° BEND (FL), 10" ASSEMBLY: 8"x8" REDUCING 90° BEND (FL)
  - 11. 4" ASSEMBLY, 4" TEE (FL)
  - 12. 4" ASSEMBLY, 8"x8"x6" TEE (FL)
  - 13. 4", 6", 8", OR 10" DI CLASS 52 NIPPLE PIPE, CEMENT LINED, LENGTH TO FIT, WITH TIE RODS PER DISTRICT STANDARD.
  - 14. 4", 6", 8", OR 10" FLANGED COUPLING ADAPTER
  - 15. DETECTOR DOUBLE CHECK VALVE ASSEMBLY. EACH ASSEMBLY SHALL INCLUDE TWO RESILIENT WEDGE GATE VALVES AND TEST COCKS, BY-PASS ASSEMBLY, AND BE APPROVED CROSS-CONNECTION CONTROL ASSEMBLIES PER THE LATEST D.O.H. APPROVED LIST.
  - 16. ADJUSTABLE PIPE SUPPORT UNDER CHECK VALVES EQUAL TO STANDON MOD. #592 (THREE REQUIRED).
  - 17. 4", 6", 8", OR 10" (FLxPE) PIPE WITH COLLAR 18" FROM PE: 4" - 5'-6" LONG 6" - 4'-6" LONG 8" - 3'-6" LONG 10" - 3'-0" LONG
  - 18. PRECAST CONCRETE VAULT WITH LOCKING STEEL COVERS, COVER EQUAL TO LW PRODUCTS COMPANY TYPE "AD." VAULT EQUAL TO UTILITY VAULT CO. #612-1A.
  - 19. 6" MIN. DRAIN WITH SCREEN TO DAYLIGHT OR STORM DRAIN SYSTEM, PROVIDE RODENT PROOF SCREEN AT DAYLIGHT.
  - 20. FREE STANDING GALVANIZED STEEL LADDER ATTACH TO FLOOR AND VAULT WALL.
  - 21. 4", 6", 8", OR 10" FLANGED COUPLING ADAPTER



Belfair Water District  
Standard Water Details

**Fire Service Connection**

REVISED: OCTOBER 2019



**Fire Service Connection**

11.15.2020 1:55:17 PM User: rick.mcmahon\field IN: PROJECTS\0738 MASON TRANSIT AUTHORITY\0738.05 MTA PARK AND RIDE DEVELOPMENT\CADD\BELFAIR\0738.05-WA-4-BD.WG

Δ	REVISIONS	DATE	BY	DESIGNED BY:	ISSUE DATE:
1	BID ADDENDUM 1	7/24/20	SCJ	P. HOLM	07/08/2020
				DRAWN BY:	JOB No.:
				N. MAYFIELD	0738.05
				CHECKED BY:	DRAWING FILE No.:
				P. HOLM	0738.05-WA-2-B

ALL DIMENSIONS SHOWN IN FEET UNLESS OTHERWISE DESIGNATED

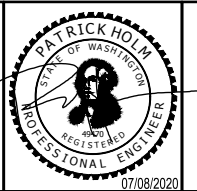

**SCJ ALLIANCE**  
CONSULTING SERVICES  
8730 TALLON LANE NE, SUITE 200, LACEY, WASHINGTON 98516  
P: 360-352-1465 F: 360-352-1509  
SCJALLIANCE.COM

PROJECT NAME:



MASON TRANSIT AUTHORITY  
BELFAIR  
PARK AND RIDE DEVELOPMENT

WATER DETAILS

DRAWING No.: WA-4  
SHEET No.: 28 OF 86